

10K Turnaround

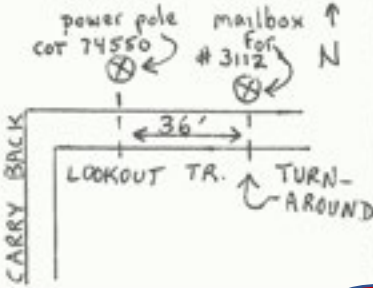

Turnaround – Directly across the street from mailbox at 3112 Lookout Trail. Turnaround should be centered in the southern lane (across the street from mailbox). Mark is 125 clicks east of the perpendicular line to the telephone pole labeled COT 74550

3 Mile – 2' west of mailbox at 3132 Lookout Trail.

2 Mile – On west edge of Dark Star Trail directly across from the wooden post on the north end of the northernmost (2nd) field opening for the backyard of 5660 Santa Anita Drive.

4 Mile – 6' east of the western (brick) bulkhead for the driveway of 3285 Lord Murphy Trail.

2 Mile – 4' south of mailbox at 3341 Lucky Debonair Trail.

Turnaround – One foot south of the intersection of the northern edge of the driveway and the road in front of 3432 Gallant Fox Trail.

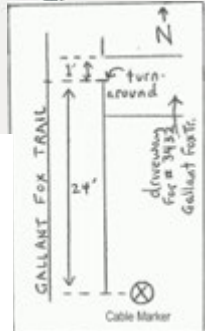

5K Turnaround

5 Mile – Straight across from the mailbox at 3520 Whirlaway Trail.

1 Mile – 51' WSW of mailbox for 5654 Santa Anita Drive.

3 Mile – 117' NE of gate to faculty/staff parking lot behind Roberts Elementary School. Also 2' South of the second tree north of the Montford Middle School staff parking lot.

6 Mile – On northeastern (outbound) lane of Pimlico Drive directly across from the school clock at Roberts Elementary School. Align with post of fence that is centered between the two

Start/Finish – At south end of Faculty/Staff parking lot behind school. Mark is 22'6" south of southernmost light pole in the easternmost median of the lot. Near end of southeastern (outside) lane of parking lot.

TRENT 10K & 5K Course Map

- Race in Progress – 12
- Turn Arrow – 12
- Traffic Cones – 26
- Turnaround

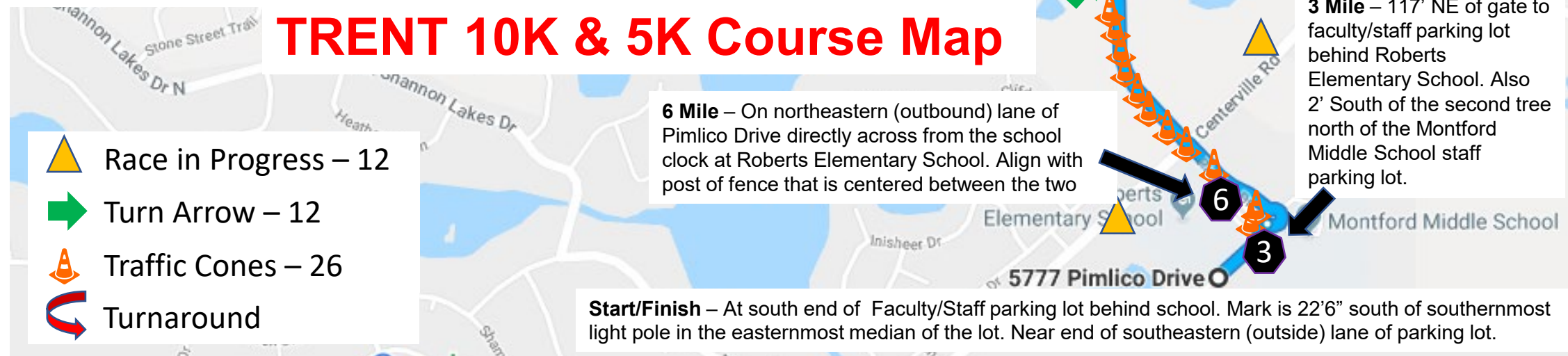

5K Marks

Start/Finish – At south end of Roberts Elementary School Faculty/Staff parking lot behind school. Mark is 22'6" south of southernmost light pole in the easternmost median of the lot. Near end of southeastern (outside) lane of parking lot.

1 Mile – 51' WSW of mailbox for 5654 Santa Anita Drive.

Turnaround – One foot south of the intersection of the northern edge of the driveway and the road in front of 3432 Gallant Fox Trail.

2 Mile – On west edge of Dark Star Trail directly across from the wooden post on the north end of the northernmost (2nd) field opening for the back yard of 5660 Santa Anita Drive.

3 Mile – 117' NE of gate to faculty/staff parking lot behind Roberts Elementary School. Also 2' South of the second tree north of the Montford Middle School staff parking lot.

10K Marks

Start/Finish – At south end of Roberts Elementary School Faculty/Staff parking lot behind school. Mark is 22'6" south of southernmost light pole in the easternmost median of the lot. Near end of southeastern (outside) lane of parking lot.

1 Mile – 50' WSW of mailbox for 5654 Santa Anita Drive.

2 Mile – 4' south of mailbox at 3341 Lucky Debonair Trail.

3 Mile – 2' west of mailbox at 3132 Lookout Trail.

Turnaround – Directly across the street from mailbox at 3112 Lookout Trail. Turnaround should be centered in the southern lane (across the street from mailbox). Mark is 125 clicks east of the perpendicular line to the telephone pole labeled COT 74550.

4 Mile – 6' east of the western (brick) bulkhead for the driveway of 3285 Lord Murphy Trail.

5 Mile – Straight across from the mailbox at 3520 Whirlaway Trail.

6 Mile – On northeastern (outbound) lane of Pimlico Drive directly across from the school clock at Roberts Elementary School. Align with post of fence that is centered between the two